

# Tal VenaTrac™\* Over-the-Wire Insertion Stylets guide

## Palindrome™ and Palindrome™

### Precision chronic dialysis catheters

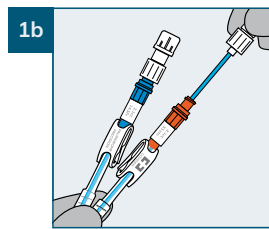
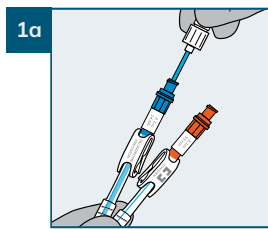

1. Load the Tal VenaTrac™ stylets into each catheter lumen. Ensure that the flat white side of each stylet is oriented against the inner septum of the catheter lumen. Lock the Tal VenaTrac™ stylet hubs to the lumen adapters. For initial insertions: Load the stylets into the catheter lumens such that a minimum length of 8 cm extends distal from the catheter adapters to allow for proper catheter tunneling.

**Note:** Flushing the Tal VenaTrac™ stylets with sterile saline and wetting the outer surfaces of the Tal VenaTrac™ stylets prior to use may facilitate advancement into the catheter.

**Optional:** To ease insertion of the catheter, the vein can be predilated with the dilator(s) provided.

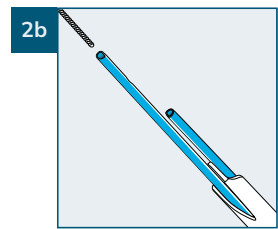
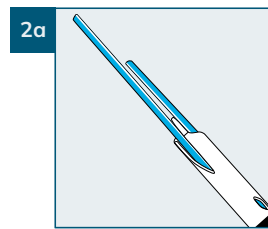

- 2a. When fully loaded and locked, the tips of the Tal VenaTrac™ stylets will be staggered. Thread the dilator(s) over the end of the guidewire and advance it into the vein using a rotating motion to assist passage through the tissue.

**Caution:** Do not force the dilator(s). Ensure that the guidewire moves freely within the dilator(s) and does not advance further into the vein. Remove and discard the dilator(s).

- 2b. Thread the guidewire 1 cm into the distal tip of the longer stylet such that it exits the stylet side hole. To assist the guidewire exit, the longer stylet tip should be flexed 45 degrees.

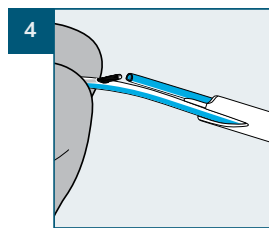
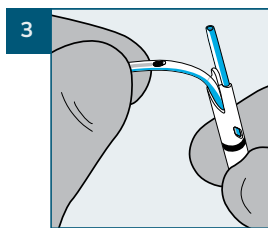

3. Advance the guidewire such that it exits the side hole of the longer stylet. To assist the guidewire exit, the longer stylet should be flexed 45 degrees.

4. Continue by threading the wire into the distal tip of the adjacent shorter stylet.

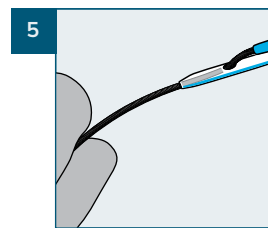

5. Advance the wire until it passes out of the distal end of the catheter-stylet assembly. While maintaining control of the guidewire, pinch the catheter stylet firmly, approximately 2 cm from the distal tip, and advance into the vein.

**Note:** For difficult placements, if so desired, the catheter may be rotated in a clockwise direction to ease advancement. If excessive resistance is felt, stop advancement and retract the entire assembly. Verify that the guidewire has not knotted or kinked and reattempt catheter advancement.

**Caution:** Do not force the assembly. Ensure that the guidewire does not advance further into the vein.

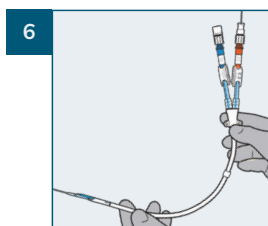

6. Continue to pinch slightly and advance the catheter-stylet assembly until the catheter tip is positioned as desired. Holding the catheter in place, gently remove the guidewire and discard. Per Dialysis Outcome Quality Initiative (DOQI) guidelines, the catheter tip must be adjusted to the level of the caval atrial junction or beyond to ensure optimal blood flow. Next, immediately unlock, remove and discard both of the Tal VenaTrac™ insertion stylets.

**Caution:** Do not remove the insertion stylets while the guidewire is in place as it may result in catheter damage. Ensure that the catheter does not move out of the vein while removing insertion stylets



**Caution:** If the guidewire meets resistance, do not pull it back through the catheter-stylet assembly. Remove the catheter, insertion stylets and wire together as a unit and begin again with a new catheter.

# Palindrome™ and Palindrome™ Precision Chronic Catheter with Tal VenaTrac™\* Over-the-Wire Insertion Stylets

| Product Code  | Insertion Length | Overall Length | Priming Volumes |               | Qty / Box |
|---|------------------|----------------|-----------------|---------------|-----------|
|   |                  |                | Arterial (Red)  | Venous (Blue) |           |
| Palindrome™ Chronic Catheter Kits                               |                  |                |                 |               |           |
| 8888145039  | 19 cm            | 36 cm          | 1.6 cc          | 1.6 cc        | 5         |
| 8888145040  | 23 cm            | 40 cm          | 1.9 cc          | 1.9 cc        | 5         |
| 8888145041  | 28 cm            | 45 cm          | 2.1 cc          | 2.1 cc        | 5         |
| 8888145042  | 33 cm            | 50 cm          | 2.3 cc          | 2.3 cc        | 5         |
| Palindrome™ Precision Chronic Catheter Kits                     |                  |                |                 |               |           |
| 8888145039P   | 19 cm            | 36 cm          | 1.6 cc          | 1.6 cc        | 5         |
| 8888145040P   | 23 cm            | 40 cm          | 1.9 cc          | 1.9 cc        | 5         |
| 8888145041P   | 28 cm            | 45 cm          | 2.1 cc          | 2.1 cc        | 5         |
| 8888145042P   | 33 cm            | 50 cm          | 2.3 cc          | 2.3 cc        | 5         |
| Palindrome™ H - Heparin coated Chronic Catheter Kits*           |                  |                |                 |               |           |
| 8888145043C   | 19 cm            | 36 cm          | 1.6 cc          | 1.6 cc        | 5         |
| 8888145044C   | 23 cm            | 40 cm          | 1.9 cc          | 1.9 cc        | 5         |
| 8888145045C   | 28 cm            | 45 cm          | 2.1 cc          | 2.1 cc        | 5         |
| 8888145046C   | 33 cm            | 50 cm          | 2.3 cc          | 2.3 cc        | 5         |
| Palindrome™ Precision H - Heparin coated Chronic Catheter Kits* |                  |                |                 |               |           |
| 8888145043CP  | 19 cm            | 36 cm          | 1.6 cc          | 1.6 cc        | 5         |
| 8888145044CP  | 23 cm            | 40 cm          | 1.9 cc          | 1.9 cc        | 5         |
| 8888145045CP  | 28 cm            | 45 cm          | 2.1 cc          | 2.1 cc        | 5         |
| 8888145046CP  | 33 cm            | 50 cm          | 2.3 cc          | 2.3 cc        | 5         |

| Components                                     | Qty |
|--|-----|
| 14.5 Fr Palindrome™ Catheter                   | 1   |
| Tal VenaTrac™™ Over-the-Wire Insertion Stylets | 2   |
| 16 Fr Valved Pull-Apart Safety Sheath          | 1   |
| Bifurcated Tunneler                            | 1   |
| 12 Fr Tissue Dilator                           | 1   |
| 14 Fr Tissue Dilator                           | 1   |
| Injection Sealing Caps                         | 2   |
| Introducer Needle, 18 g                        | 1   |
| J/Straight 0.038" × 120 cm Guidewire           | 1   |
| Syringe, 12 cc                                 | 1   |
| #11 Scalpel                                    | 1   |
| Telfa™™ Island Dressings                       | 2   |
| 4 × 4" Cotton Gauze Sponges                    | 4   |

Mozarc Medical  
 EMEA Regional Headquarters  
 Via Varesina, 162  
 20156 Milano MI, Italy

 [emeacontactus@mozarcmedical.com](mailto:emeacontactus@mozarcmedical.com)  
 [mozarcmedical.com/products/emea-en](https://mozarcmedical.com/products/emea-en)  
 LinkedIn

**IMPORTANT:** Please refer to the package insert for complete instructions, contraindications, warnings and precautions.  
 Mozarc Medical is a DaVita | Medtronic company.  
 Copyright © 2024 Mozarc Medical Holding LLC.  
 Mozarc, Mozarc Medical, the Mozarc Medical logos, and Empowering Patients. Enriching Lives. are trademarks of Mozarc Medical.  
 ™\* Third-party brands are trademarks of their respective owners.  
 12/2024. EMEA-RC-2400053